

CATALOGUE

PREMIUM
MODULAR
HOUSES

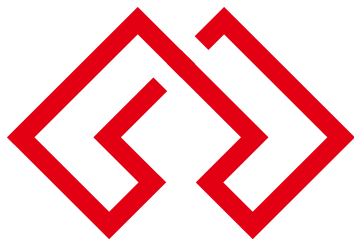

MTB Modules
premium modular building systems



IN PARTNERSHIP WITH
GREEN ARC LEISURE



We are very pleased to hand over to you this catalog, which is the culmination of our many months of work.

MTB Modules is a premium brand, offering modern modular building solutions. We address our offer to both retail and business customers.

Thanks to our hard work, we have developed sales channels in 13 countries around the world. We are characterized by high quality materials with ease of installation. Customers appreciate our professionalism and continuous development, and We do everything to make Our firm reach every corner on Earth. We set a new quality in modular house systems.

We prepare an offer strictly tailored to the customer's needs, and you can see it in a specially prepared **SHOWROOM** of our firm in Chojnice.

Our mission is to create a friendly, safe place to live.

List

PAGE

04
06
08
10
12
14
16
18
20
22
24
26
28
30
32
34
36
38
40
42
44
46
48

50
52
54

HOUSES

MTB ONE
MTB ONE WHITE EPS
MTB ONE PLUS
MTB ONE PLUS WHITE
MTB FOUR
MTB FIVE
MTB SIX
MTB SIX PLUS
MTB SEVEN
MTB SEVEN WHITE
MTB A
MTB 15
MTB 30
TINY HOUSE
TINY HOUSE DOUBLE
MTB T
MTB T WHITE
MARINA MODULE
ROW HOUSE
SERIA UNIVERSAL
MOBILE HOME L
MOBILE HOME XL
HOUSE BOAT

FOR BUSINESS
MICRO HOTEL ROOM
HOTEL MODULE MEDICAL
MODULE

MTB ONE



Parameters:

HOUSE SIZE: with mezzanine **35 m**

HOUSE DIMENSIONS - EXTERIOR:

WIDTH: 4,94 m

LENGTH: 6,91 m

HEIGHT: 4,92 m

ROOF ANGLE: 18°

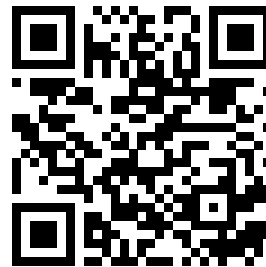



The MTB One model is a combination of elegance and functionality. It is a house with an area of 35 m². A large terrace window makes the entire living room filled with sunlight, and its location allows comfortable access to the garden. The house has a mezzanine floor, which can be developed into a bedroom. This will allow you to separate the living zone from the night zone, without adding additional square meters. A stylish terrace canopy is an additional option, which not only allows you to get a bit of shade on sunny days, but also adds charm and appeal. MTB One is a timeless model that always fits in with the atmosphere of its surroundings. It allows us to be multifunctional in a relatively small space.

MTB ONE WHITE EPS



Parameters:

HOUSE SIZE: with mezzanine **35 m**

HOUSE DIMENSIONS - EXTERIOR:

WIDTH: 4,94 m

LENGTH: 6,91 m

HEIGHT: 4,92 m

ROOF ANGLE: 18°

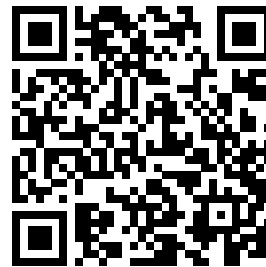

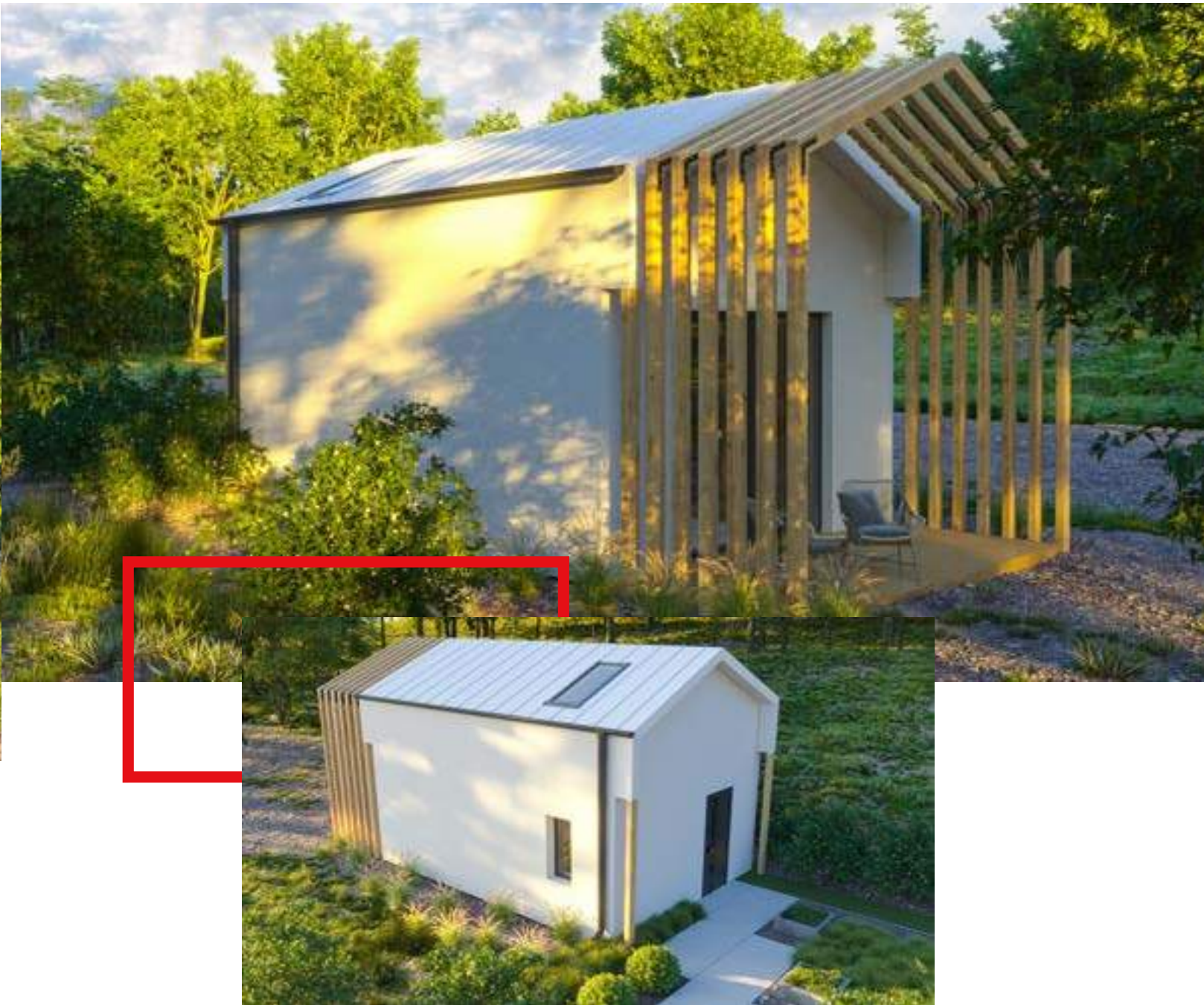

MTB ONE EPS is a model based on the MTB ONE house. The new version is characterized by white plaster, which allows the facade to be arranged in any color chosen by the client. It has a glazed, spacious living room that brings light to the entire area of the house. There is also an exit to the garden behind the glass. The cozy bedroom, located on the entire mezzanine area, is definitely something special. In addition, a small but functional bathroom is everything you could want from a house. Created with the highest quality materials, this is the place to spend unforgettable moments in life.

MTB ONE PLUS



Parameters:

HOUSE SIZE: with mezzanine **35 m**

HOUSE DIMENSIONS - EXTERIOR:

WIDTH:: 4,94 m

LENGHT: 6,91 m

HEIGHT: 4,92 m

ROOF ANGLE: 18°

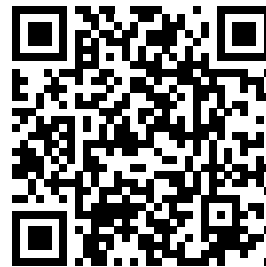



MTB One Plus is a richer version of MTB One. The house is distinguished by large, impressive terrace windows, across the entire gable wall. They beautifully illuminate both the living room and the mezzanine. The rays of the rising sun streaming into the bedroom area will make every morning special. A large window on the first floor also serves as an additional exit to the terrace, which can be covered with a stylish pergola. It belongs to the additional options and gives an amazing effect to the whole. The house with an area of **35 m²** allows you to stylishly furnish a bathroom, a spacious living room with a functional kitchenette and a cozy bedroom. A perfectly refined staircase of our production leads upstairs.

MTB ONE PLUS WHITE



Parameters:

HOUSE SIZE: with mezzanine **35 m**

HOUSE DIMENSIONS - EXTERIOR:

WIDTH: 4,94 m

LENGTH: 6,91 m

HEIGHT: 4,92 m

ROOF ANGLE: 18°

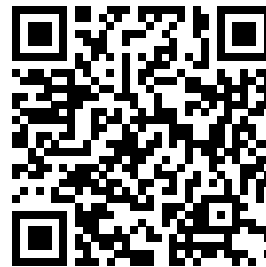



MTB ONE PLUS WHITE is a house that definitely boasts excellent lighting. The 35m² house is illuminated by large, almost all-wall windows. They are extendable and allow access to the garden. To add atmosphere to the terrace, a stylish pergola made of high-quality wood is offered as an additional option. MTB One Plus White is distinguished from the basic version by a sensationally lit mezzanine, where we can design a cozy bedroom. On the first floor, a living room with a kitchenette will fit perfectly. This is a great solution for small spaces. Thanks to the open living room we get a modern atmosphere of the house. Following the voice of the client, the facade of the house was made of sheet metal also in white color.

MTB FOUR



Parameters:

HOUSE SIZE: two-story **70 m**

HOUSE DIMENSIONS - EXTERIOR:

WIDTH: 4,94 m

LENGHT: 6,94 m

HEIGHT: 5,40 m

ROOF ANGLE: 18°

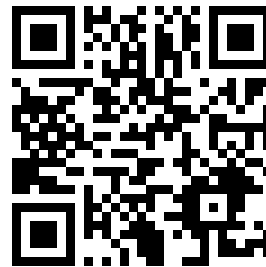



MTB FOUR is a two-story house, with a total area of 70 m². It is a breath of fresh air on the market of modular houses. The area on the first floor allows space for a spacious, glazed living room with a functional kitchenette and a comfortable bathroom. Exit to the garden is made possible by large balcony doors, located in the living room. The first floor of the house allows for two or even three bedrooms and a spacious bathroom with bathtub and shower. The master bedroom has an unparalleled charm, thanks to large glass windows located on the entire wall. The top is further illuminated by two skylights. This model is very popular, due to the combination of its functionality along with its elegant style. As additional options, we offer a pergola, which will give shade on sunny days and the impression of an aesthetic whole. The model is also available in a white color version.

MTB FIVE



Parameters:

HOUSE SIZE: with mezzanine **30 m**

HOUSE DIMENSIONS - EXTERIOR:

WIDTH: 3,75 m

LENGHT: 7,82 m

HEIGHT: 4 m

ROOF ANGLE: 35°

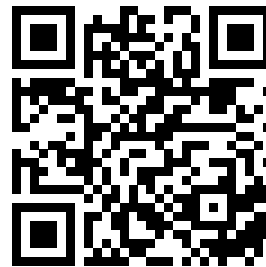



MTB FIVE is a house with a small area of 30 m². With its unusual "diamond" elevation, it fits in with the new trends in architecture. Thoughtful layout of the rooms allows for a spacious living room with kitchenette, bathroom and a small room on the first floor. In addition, in this small model one more place has been set aside for a bedroom, located on the mezzanine. Large glazings in the living room on the area of almost the entire wall optically enlarge the space and provide an excellent view of the garden. A balcony door serves as a second entrance to the house. The small house fully provides high living and aesthetic comfort.

MTB SIX



Parameters:

HOUSE SIZE: two-story **88 m**

HOUSE DIMENSIONS -

EXTERIOR: WIDTH: 4,92 m

LENGHT: 10 m

HEIGHT: 5,40 m

ROOF ANGLE: 18°

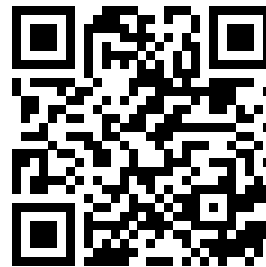

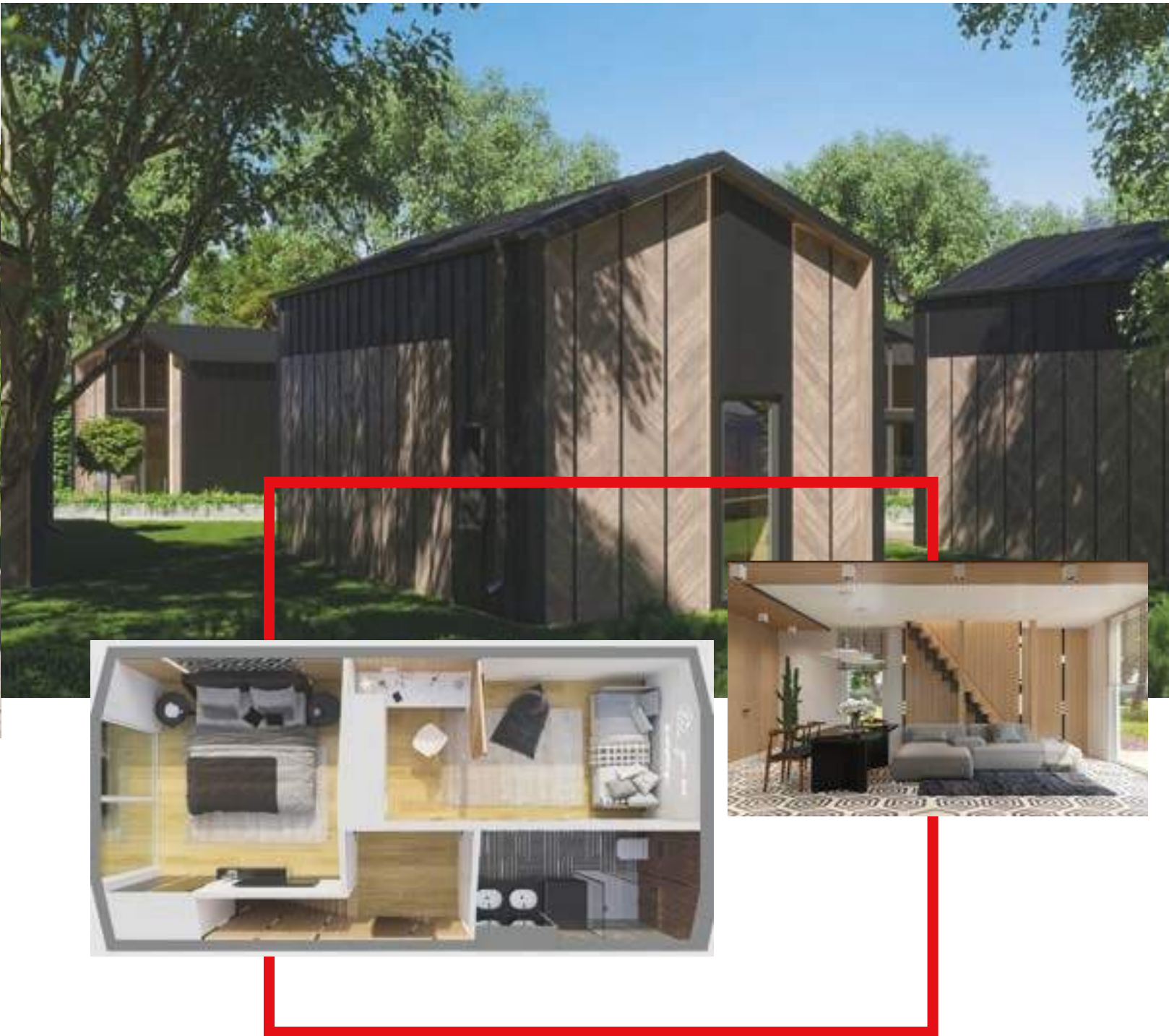

MTB SIX with an area of **88 m²** is a spacious and modern house that definitely fits into today's standards. Thanks to its spaciousness and innovation, it meets the expectations of the most demanding customers. A spacious, glass-enclosed living room with a kitchenette allows for a separate relaxation area. The well-planned layout of the rooms makes it possible to develop a vestibule with a large built-in closet. On the first floor there is also space for an additional bedroom and a bathroom. The first floor of the house is divided into two bedrooms and a versatile bathroom. The house stands out from other models because of its seamed metal facade, combined with a herringbone facade board. Thus, we get a multifunctional house with a timeless look and top quality.

MTB SIX PLUS



Parameters:

HOUSE SIZE: with garage **123 m**

HOUSE DIMENSIONS - EXTERIOR:

WIDTH: 11,26 m

LENGHT: 10 m

HEIGHT: 5,50 m

ROOF ANGLE: 18°

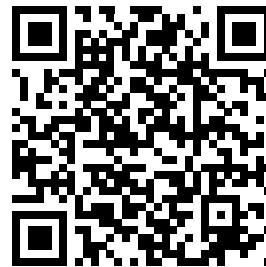



MTB SIX PLUS is a two-story house with a garage with a total area of 123 m². Probably one of the largest modular homes on the market. It will easily accommodate the whole family. It is an extension of the MTB SIX model. It is additionally equipped with a garage with an automatic garage door. The house is revolutionizing the modular home market, and is very impressive in its appearance. Thoughtful layout of rooms, allows up to 4 bedrooms and two bathrooms. A glazed living room with a kitchenette and a view of the garden will make every evening unforgettable. The upstairs, in addition to the glazed wall, is also illuminated by 4 skylights. The facade of the house is made of the highest quality sheet metal in anthracite color. This is a modern house, creating a lot of interest in the market.

MTB SEVEN



Parameters:

HOUSE SIZE: with garage **120 m**

HOUSE DIMENSIONS - EXTERIOR:

WIDTH: 6,16 m

LENGHT: 10,86 m

HEIGHT: 7,13 m

ROOF ANGLE: 45°

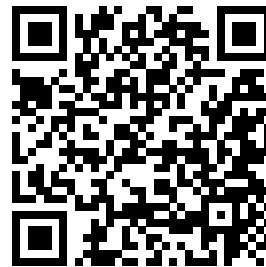



MTB SEVEN is one of our largest models, with a total area of as much as 120 m². Its most distinctive feature is the large glazing, occupying almost the entire gable wall. The entire house is modeled after the very popular barn look. A large terrace door, which is an exit to the garden, conceals a spacious living room with a kitchenette. The layout of the rooms allows for 4 bedrooms and two bathrooms. The largest, glazed bedroom on the first floor gives an amazing atmosphere to this house. A spacious bathroom with the possibility of installing a bathtub and shower, and a smaller one downstairs. This is all you can get when you buy the model of your choice. The custom design of the house allows you to furnish it in any style. The facade is made of the highest quality sheet metal.

MTB SEVEN WHITE



Parameters:

HOUSE SIZE: with garage **120 m**

HOUSE DIMENSIONS - EXTERIOR:

WIDTH: 6,16 m

LENGHT: 10,86 m

HEIGHT: 7,13 m

ROOF ANGLE: 45°

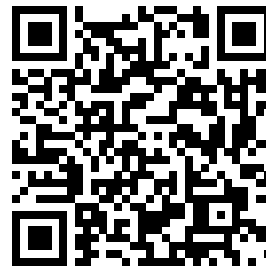



MTB SEVEN WHITE is a revolver on the modular home market. With an area of 120 m², there will be room for 4 stylish bedrooms, including one on the first floor, three on the first floor. The master bedroom will be able to delight in the view, because of the glazed main wall. The rising and setting sun will give a wonderful atmosphere in this room. The glazed wall is also located on the first floor in the living room with kitchenette. The windows also serve as an additional exit, leading straight to the garden. On both floors there will be space for two comfortable bathrooms with a bathtub or shower. All according to the client's preferences. The main door will lead into the house, in anthracite color, perfectly harmonizing with the white tin facade of the house. It is behind this door that we have set aside space for a hallway with a wardrobe area. The whole house is a dream come true for those who would like to feel a whiff of rurality in the city.

MTB **A** soon



Parameters:

HOUSE SIZE: **20 m**

HOUSE DIMENSIONS -

EXTERIOR:

WIDTH: soon

LENGHT: soon

HEIGHT: soon

ROOF ANGLE: soon

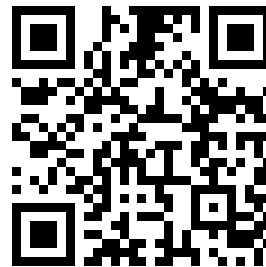



MTB A is a combination of unique design and multifunctionality. Created for those who like modern solutions. It delights with its unusual shape and timeless anthracite facade. On an area of only 20 m² we found space for a living room, kitchen, bathroom and bedrooms. Entering the main entrance, we can be charmed by the stylishly decorated living room with kitchenette. It is the heart of the house. On the first floor behind the door is a compatible bathroom with space for a shower cubicle. To move to the atmospheric bedroom, just climb the stairs leading upstairs. The most important feature of the mezzanine is the floor-to-ceiling glazed wall, which is captivating in appearance. Every morning with the sunrise and every evening with a view of the stars is something not to forget.

MTB 15 soon



Parameters:

HOUSE SIZE: **15 m**

HOUSE DIMENSIONS -

EXTERIOR:

WIDTH: soon

LENGHT: soon

HEIGHT: soon

ROOF ANGLE: soon

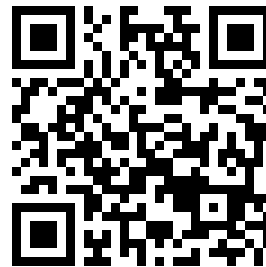



MTB 15 is a delightful little house of 15 m². And what impresses most about it? Its unconventional construction. The design of the building allows us to get away from reality. It creates the impression of expensive and exclusive. The slants of the house give it a modern look, and the large windows on almost the entire wall, not only illuminate, but also optically enlarge the house. Created for those who do not like boredom. It combines modernity with functionality. Allows separation of the living and sleeping areas. The transparent living room with kitchenette is the place that makes the biggest impression in this model. MTB 15 - let yourself be surprised.

MTB 30 soon



Parameters:

HOUSE SIZE: **30 m**

HOUSE DIMENSIONS -

EXTERIOR:

WIDTH: soon

LENGHT: soon

HEIGHT: soon

ROOF ANGLE: soon

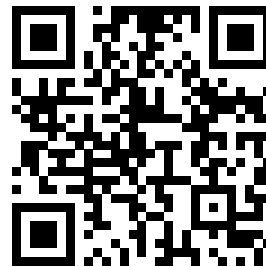



MTB 30 awakens everyone's interest. A 30 m² house, it is just what you are looking for. Its modern design definitely sets it apart from other models. The subtle pergola, located above the main entrance, gives it charisma and uniqueness. The layout of the rooms easily allows you to separate space for an atmospheric bedroom, an open living room with a functional kitchenette, as well as a stylish bathroom, meeting the highest standards. The elevation partly made of sheet metal, partly of wood is a great combination, which is memorable for a long time. Everything is made of the highest quality raw materials and materials. This house, accompanied by greenery, will make you never want to leave it again.

MTB TINY HOUSE



Parameters:

HOUSE SIZE: **33,6 m**

HOUSE DIMENSIONS -

EXTERIOR:

WIDTH: 3,8 m

LENGHT: 10,5 m

HEIGHT: 3,2 m

ROOF ANGLE: 18°

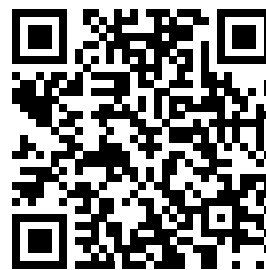



TINY HOUSE is a modular house with a modern design and an area of 33 m². It will work perfectly not only as a summer house, but also as a year-round house. Fully mobile design will allow us not to stop in one place. It will be perfect for those who like change. In a small space we obtained a vestibule, a spacious living room with a kitchenette, a functional bathroom and a cozy bedroom. It is a model that also offers the highest quality interior furnishings such as : kitchenette, equipped with a bakery, refrigerator, cooker hood, induction hob and sink. The bathroom is equipped with a shower cubicle, wall cabinets, a ladder radiator, a sink, a toilet, towel hangers, and tiles on the floor and walls. The atmospheric bedroom features a double bedroom bed with a comfortable mattress, two bedside tables, a chest of drawers and a matching modern chandelier. The living room is equipped with a large closet, a TV cabinet, a sofa bed and wall-mounted shelves. Large windows located in almost every room provide excellent light to the house. The facade, partly made of sheet metal and partly made of wood, also gives it a unique look.

MTB TINY HOUSE DOUBLE



Parameters:

HOUSE SIZE: **33,6 m**

HOUSE DIMENSIONS -

EXTERIOR:

WIDTH: 3,8m

LENGHT: 10,5m

HEIGHT: 3,2 m

ROOF ANGLE: 5°

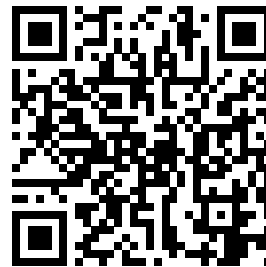



TINY HOUSE DOUBLE is a phenomenon among mobile homes. Its stylish, decorative facade catches the eye, and the thoughtful placement of windows perfectly illuminates the house. The two-story building with an area of 22.5 m² meets the standards of a full-size house. Entering the interior, we are shown a stylishly decorated kitchen with a separate area for relaxation. In the house we can also find space for a dining area, which can easily accommodate 4 people. A functional bathroom with a shower cubicle, looks nothing like typical portable toilets. It is fully compact, and its area is not overwhelming. The staircase leading upwards brings us to the bedroom area. A large double bed, a capacious closet and bedside tables will fit perfectly on the extra space. The selected model is fully mobile and allows us to move to any corner of the world.

MTB T



Parameters:

HOUSE SIZE: fully equipped **20 m**

HOUSE DIMENSIONS - EXTERIOR:

WIDTH: 2,30 m

LENGHT: 5,96 m

HEIGHT: 2,54 m

ROOF ANGLE: 5°

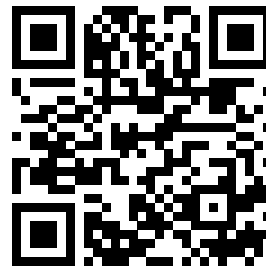



MTB T is a small, compact house of 20 m². It is our first fully equipped model. It has an additional pull-out bedroom of 5 m². It is equipped with a 32 inch Samsung TV, a metal bunk bed, a double bed with a pull-out function, a TV cabinet, a large wardrobe closet, a kitchenette, linens, towels, toilet paper, a hammock, lamps, small household appliances and a fully furnished bathroom. Thus, there is no need to select additional options for this model, as it is possible to live in it immediately after transportation. Facade in anthracite color. This is a color that will always be in fashion already and will provide an elegant appearance to the building. A stylish awning gives shade on the terrace on hot sunny days. Charming design and refined every detail makes it impossible to notice how small the area is.

MTB T WHITE



Parameters:

HOUSE SIZE: fully equipped **20 m**

HOUSE DIMENSIONS - EXTERIOR:

WIDTH: 2,30 m

LENGHT: 5,96 m

HEIGHT: 2,54 m

ROOF ANGLE: 5°

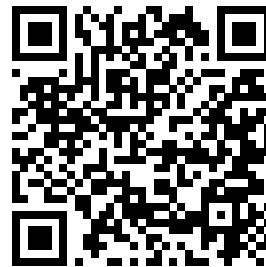



MTB T WHITE is an innovative solution in the modular home market. One of our first models of this type. It will work great both as a year-round and seasonal home. The insulated property is fully equipped and less than three hours after arrival it is already ready to move in. The 20m² space is divided into two bedrooms, a practical kitchenette and a bathroom with a shower cubicle. The cottage's furnishings include, among others, a bunk bed with two comfortable mattresses and linens, a double pull-out bed, also with mattresses and linens, a kitchenette with a sink, a dish drainer and a cordless kettle, a complete bathroom with a shower, toilet, sink, mirror, towels and even toilet paper. A 32-inch Samsung TV is mounted on the wall. Each unit undergoes quality control, which provides customers with a guarantee of the highest quality. The classic facade of the house is made of sheet metal in white. Large windows, illuminating the entire area, add charm to MTB T White. The biggest plus of our models is mobility.

MTB MARINA MODULE



Parameters:

HOUSE SIZE: **34,86 m**

HOUSE DIMENSIONS -

EXTERIOR:

WIDTH: 4,20 m

LENGHT: 8,24 m

HEIGHT: 3,04 m

ROOF ANGLE: 5°

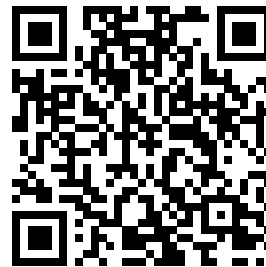



MARINA MODULE is a modern, year-round modular house of 35 m². Mobile construction, based on a steel frame in combination with Scandinavian wood creates a product of the highest quality. Despite the relatively small size in our houses, it is impossible to feel that you are in a mobile or summer building. The interior height of 250 cm, the weight and stability give comfort comparable to a top-quality hotel room. The Marina module is significantly different from Dutch cottages or wooden summer houses. Convenient layout of the rooms allows us to have space for a glazed living room with kitchenette, a comfortable bedroom area and a functional bathroom.

MTB ROW HOUSE



Parameters:

HOUSE SIZE: **98 m**

HOUSE DIMENSIONS -

EXTERIOR:

WIDTH: 4,17 m

LENGHT: 13,06 m

HEIGHT: 6,40 m

ROOF ANGLE: n/d

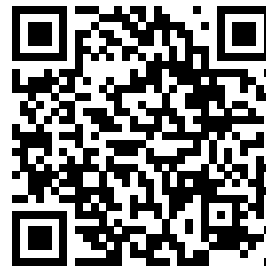



ROW HOUSE is a spacious row house. Mostly sold in two stories. The lower module provides convenient access to the terrace through a large balcony door, while the upper module is decorated with a balcony with an additional area of 6.5 m². Each module has an area of 53 m², which allows us to seamlessly develop space for a living room, kitchen, bedrooms and bathroom. By combining two modules, we can get a large 106 sqm apartment, or we can split this into two separate apartments. The thickness of the ceiling is as much as 63 cm, which means that comfortable soundproofing is ensured for two separate apartments. Assembly of the terraced house takes only about two hours. The standard of the module depends on the customer's decision, we can even deliver it fully equipped. The requirement for taking the order is to set them up in at least five two-story floors.

MTB SERIA UNIVERSAL



Parameters:

HOUSE SIZE: **individual**

HOUSE DIMENSIONS - EXTERIOR:

WIDTH: individual

LENGHT: individual

HEIGHT: individual

ROOF ANGLE: n/d

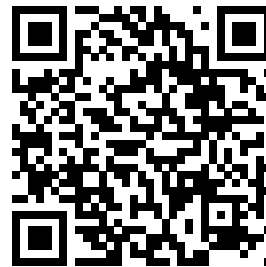



UNIVERSAL SERIES is a series of buildings designed to meet your needs. The small footprint is made imperceptible by glazing almost every wall. The elegant appearance of the facade makes it fit perfectly into any environment. It is up to you how you want to use it. Sauna, garage, changing rooms or office? No problem. A universal solution for non-universal ideas.

MTB MOBILE HOME L



Parameters:

HOUSE SIZE: **40 m**

HOUSE DIMENSIONS -

EXTERIOR:

WIDTH: 4 m

LENGTH: 10 m

HEIGHT: 3,55 m

ROOF ANGLE: 10°

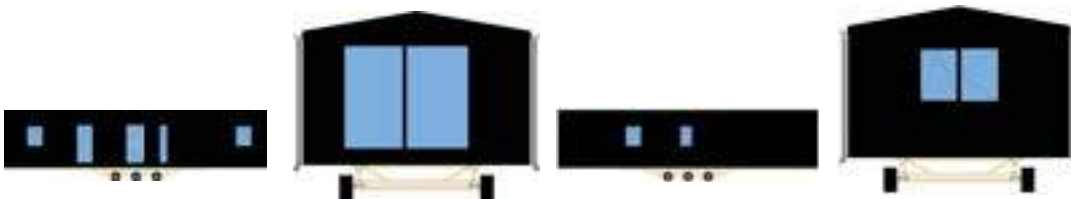
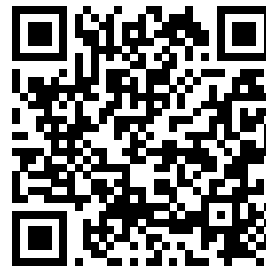



MOBILE HOME L, commonly known as a Dutchman. However, by its timeless appearance it definitely stands apart from the rest of its "brothers". The 40-square-meter mobile home surprises not only by its appearance, but also by its well-thought-out arrangement of rooms. A small space has been used for a well-lit, living room with a kitchenette, two comfortable bedrooms, providing four places to sleep, a functional vestibule and a bathroom. The building has been equipped, and includes : a kitchenette with all the most necessary appliances such as an oven, refrigerator, cooker hood, induction hob, dishwasher and sink. Bathroom with installed shower, toilet, ladder radiator and wall cabinets. The floor in it is covered with vinyl panels, and on the walls there is a monolith, imitating travertine. The master bedroom has a double bed, and the second bedroom has two single beds. The entire building is well-lit thanks to the top-quality windows located in each room.

MTB MOBILE HOME XL



Parameters:

HOUSE SIZE: **57 m**

HOUSE DIMENSIONS -

EXTERIOR:

WIDTH: 4,3 m

LENGHT: 13,3 m

HEIGHT: 3,6 m

ROOF ANGLE: 10°



MOBILE HOME XL is a home with a total area of 57 m². It stands out on the market with its spaciousness and modernist design. The house has two comfortable bedrooms equipped with beds, dressers and bedside tables. A bathroom with a shower cubicle, suspended toilet, washbasin, bathroom fittings and a washbasin cabinet with a mirror - ready for use. A large living room with a kitchenette equipped with the highest quality household appliances. All of it makes you feel like you are in a real, non-mobile home. The façade is made partly of anthracite-colored sheet metal and partly of façade wood, which gives a breath of subtlety.

Each of our mobile homes has a perfectly refined chassis that allows you to transport the object to any corner of the world.

MTB HOUSE BOAT



Parameters:

HOUSE SIZE: **48 m**

HOUSE DIMENSIONS -

EXTERIOR:

WIDTH: 4 m

LENGTH: 12 m

HEIGHT: 3,5 m

ROOF ANGLE: 2°



HOUSE BOAT was designed as a house on the water, but it will also work well on land. Total area of the house is 48 m². Additional meters will be provided by a subtle mezzanine in the living room. The facility is fully equipped and ready to move in. The building enjoys excellent lighting thanks to two large terrace windows that are located parallel to the gable walls in the living room and in the bedroom. The façade of the house is made of cladding boards and admixtures of sheet metal on the seam. Perfect for those who value style and comfort.

MTB MICRO HOTEL ROOM



Parameters:

HOUSE SIZE: **15 m**

HOUSE DIMENSIONS -

EXTERIOR:

WIDTH: 2,2 m

LENGHT: 6 m

HEIGHT: 2,5 m

ROOF ANGLE: n/d

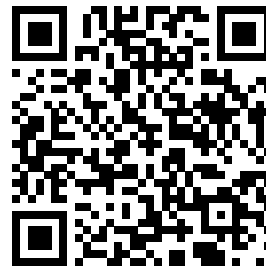



MICRO HOTEL ROOM is a small, fully equipped hotel room, with an area of 15 m². It meets every standard of the facility, from staff rooms to 5 stars. It is possible to put a module in multiple floors. Despite its small size, each room has room for a comfortable and cozy bedroom, a place to eat a meal and a functional bathroom.

MTB HOTEL MODULE



Parameters:

HOUSE SIZE: **28 m**

HOUSE DIMENSIONS - EXTERIOR:

WIDTH OF SINGLE MODULE: 3,74 m

LENGHT OF SINGLE MODULE: 6,94

m HEIGHT OF SINGLE MODULE: 3,20

m ROOF ANGLE: n/d

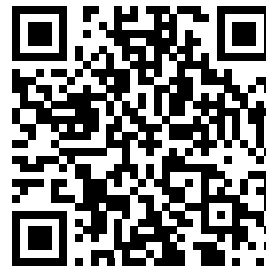

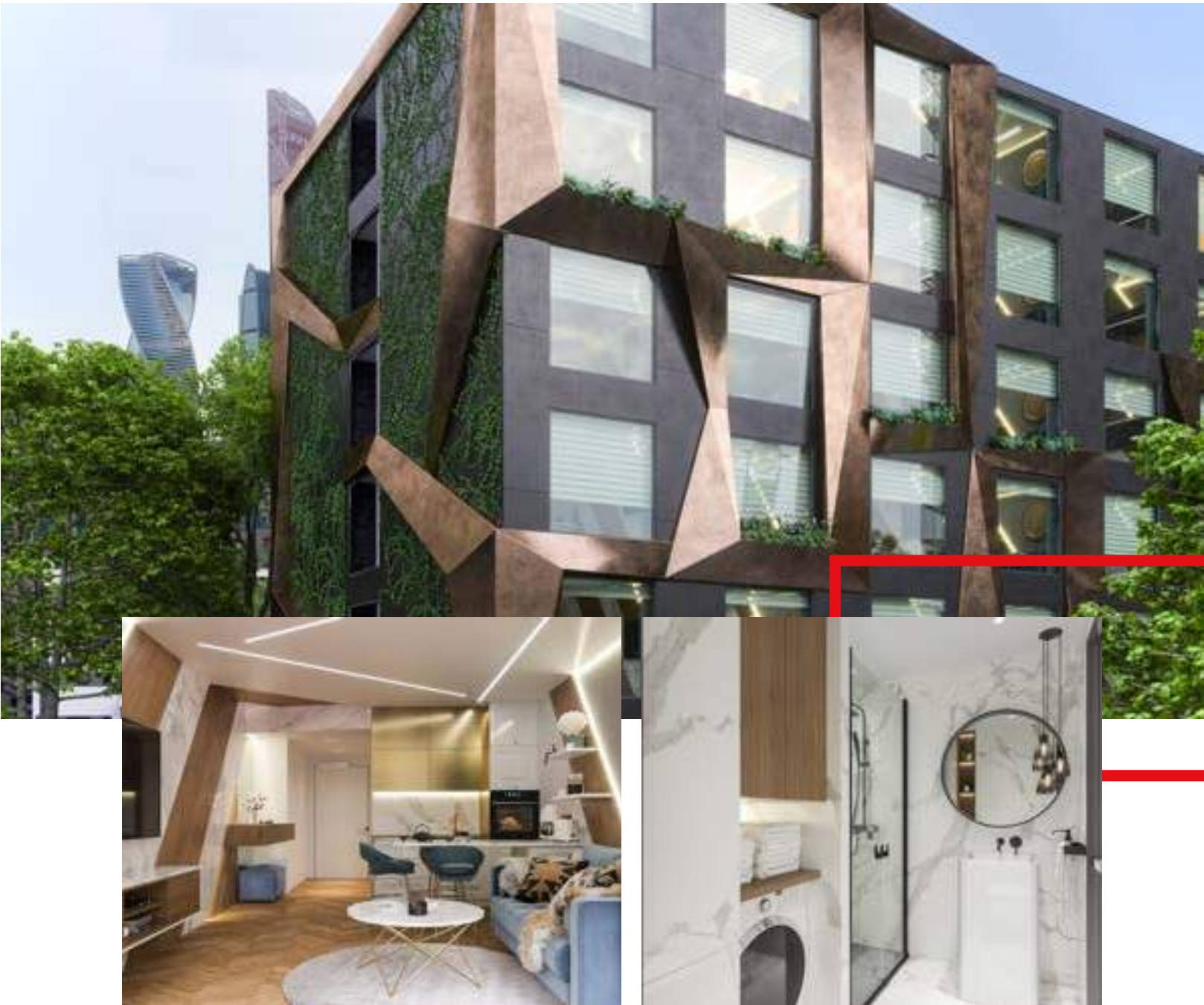

HOTEL MODULE as a facility of ready-made hotel room modules. They offer every standard, from simple hotel rooms, staff rooms to those five-star rooms. Our most awe-inspiring project is the Dubai room. This facility surpasses the standard of hotel star classifications. Among other things, it has been equipped with automatic opening and closing of doors and intelligent control of almost all appliances. It houses bedroom, relaxation, bathroom and kitchen areas. In addition, it provides excellent acoustic comfort. A great solution in the construction of modular hotels is a double module divided by a corridor, which connects successive sections. All materials used in the construction of our modules are of only the highest quality. The equipment is adapted to intensive use by tenants.

MTB MEDICAL MODULE



Parameters:

HOUSE SIZE: **35 m**

HOUSE DIMENSIONS -

EXTERIOR:

WIDTH: 4,00m

LENGHT: 9,51m

HEIGHT: 3,19m

ROOF ANGLE: n/d

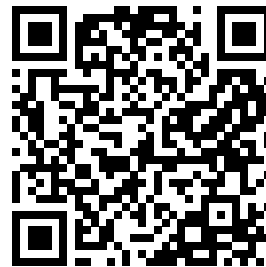



MEDICAL MODULE is a module that was created to meet the needs of the beginning of the pandemic and has fulfilled its task 100%. Certified. The offered model meets all the standards of a medical facility and is fireproof. The module was insulated by us, so its heat transmittance is relatively low. The water system is installed in the walls of the building with the possibility of heating water, through an electric heater. The facility is equipped with two ramps that allow wheelchairs to move around. Installation of the entire facility takes an average of 60 minutes. It has a pre-programmed voice information system, which operates unmanned once the module is installed at the target site. Entrance to the building is controlled according to the management system.



**MTB MODULES IN PARTNERSHIP
WITH GREEN ARC LEISURE**

Sales@greenarcleisure.co.uk

07510 278726

www.greenarcleisure.co.uk